

USER'S MANUAL

Hydraulic Hand Pallet Truck



USER'S MANUAL

Hydraulic Hand Pallet Truck

Introduction

Before attempting to use your hydraulic pallet truck, we recommend you read this manual and familiarize yourself with the details of operation.

Safety Instructions

1. Keep feet out from underneath load.
2. Balance load securely before moving it.
3. Don't load pallet truck beyond capacity.

Assembling Pallet Truck

To attach hydraulic unit to fork :

1. Insert hydraulic ram into fork frame ram socket.
2. Line up hydraulic table with holes in lifting yoke. See Figure 1.

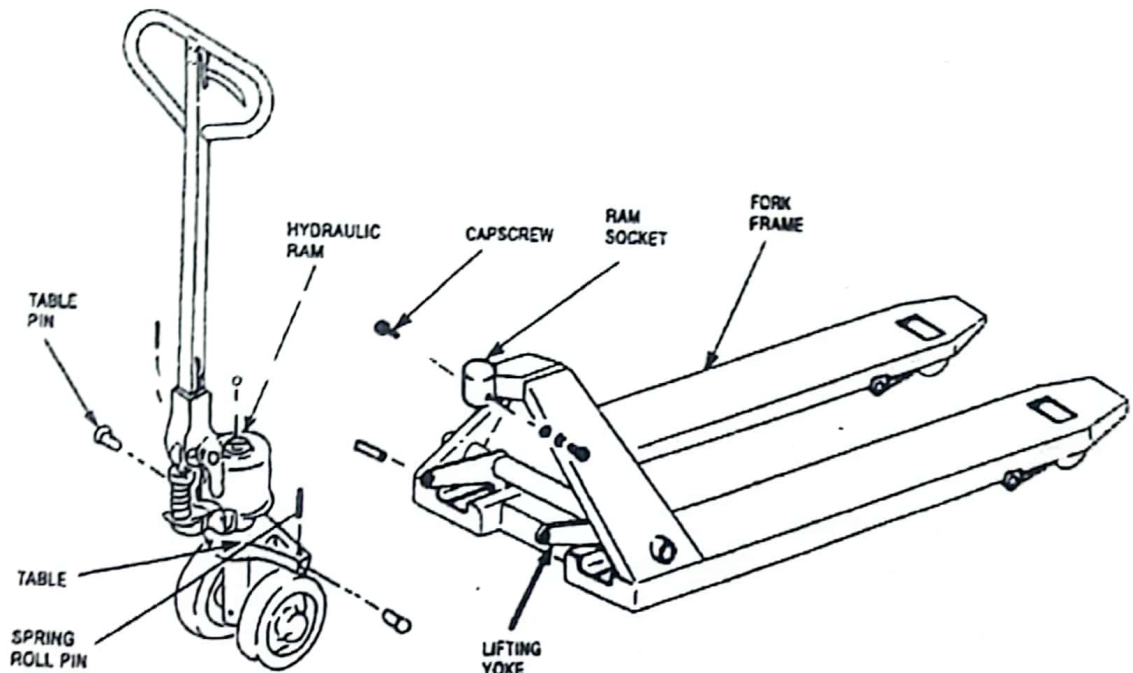

FIGURE 1
PTA

3. Insert table pins back into lifting yoke slots.
4. Line up each hole in table with holes in each table pin.
5. Insert each spring roll through table top and into hole in table pin.
6. Insert caps crews into sides of fork frame cam socket. Hydraulic unit is now assembled to fork frame.

Operating Pallet Truck

To raise fork, place handle lever in Up position (bottom part of handle slot)
See Figure 2.

To lower fork, pull lever to DOWN position (upper part of slot).

To freely move handle, set lever in NEUTRAL (center notch of slot).

To lift load:

1. Lower fork to lowest position.
2. Insert fork under load.
3. Place lever in UP position (bottom part of slot).
4. Pump handle until fork reaches desired height.

To move load:

1. Place lever in NEUTRAL Position (center notch of slot).
2. Pull or push load to desired location.

To lower load:

1. Pull lever to DOWN position (upper part of slot).

NOTE: Load is now down.

2. Pull fork away from load.

Adjusting Up-Down Cam

To adjust cam, set lever in NEUTRAL position, and turn cam nut while pumping handle.
(See Figure 3-) When no longer lifting, turn nut once more.

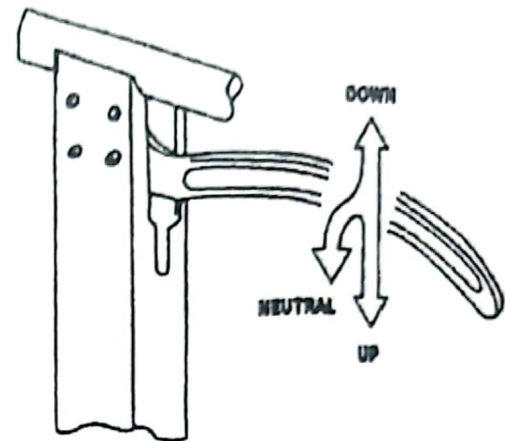

FIGURE 2

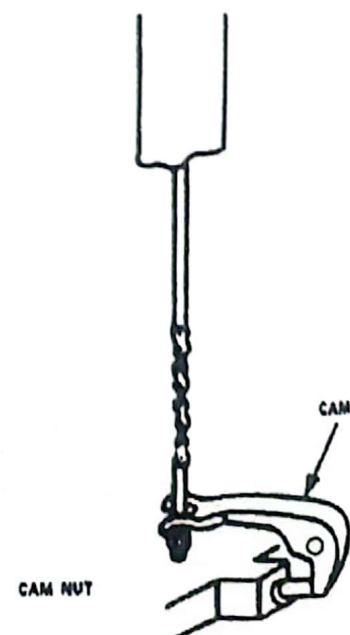

FIGURE 3

Cleaning Relief Valve

Over time, relief valve may become clogged with debris and will not work properly. To clean relief valve, flush out hydraulic system as follows: Pump handle quickly, raising pallet truck to full extent. Then quickly release pumping action.

Lubrication and Oiling

When changing or adding oil, fill tank to 80% capacity (Figure 4)

with hydraulic oil, such as:

Shell Tellus Oil.....No. 22 or 27

Turbine Oil.....No. 22

Texaco Regal.....No. 32

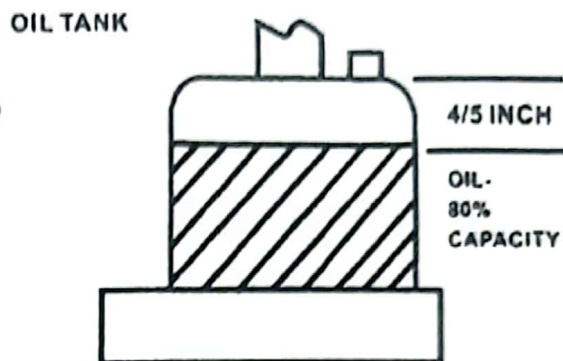

FIGURE 4

Check oil level annually.

Change grease of rear and front wheels annually.

Troubleshooting

Possible problems could arise in the operation of your hydraulic pallet truck. Their probable cause(s) and corrective action(s) follow:

Condition	Probable Cause	Corrective Action
Hydraulic unit does not lift.	Oil low in tank	Make sure of no oil leakage from valve, and add oil.
	Steel ball not seated in hydraulic unit	See "Cleaning Relief Valve" in this manual.
Once lifted, truck lowers by itself.	Worn o-ring in cylinder	Consult authorized repair station.
	Steel ball not seated in hydraulic unit	See "Cleaning Relief Valve" in this manual.
	Worn o-ring in ram cylinder	See "Cleaning Relief Valve" in this manual.
	Relief valve not seated properly	See "Cleaning Relief Valve" in this manual.
	Relief valve not adjusted properly	Reload truck within load capacity and adjust valve by pressure adjustment screw.
Fork does not lower.	Oil leakage from each valve	Tighten plug of each valve
	cam broken	Refer to "Adjusting Up-Down Cam" in this manual
	Up-down cam nut out of adjustment	Replace broken parts
Lever does not set at NEUTRAL position.	Broken fork rods and linkage	Refer to "Adjusting Up-Down Cam" in this manual
	Up-down cam nut out of adjustment.	

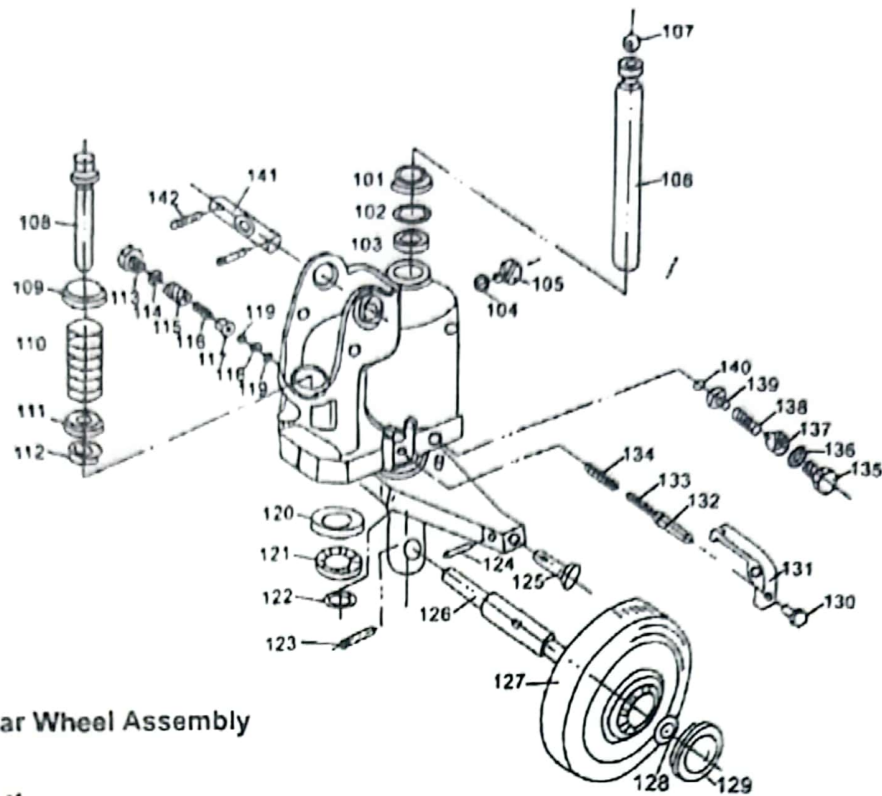

100 Pump and Rear Wheel Assembly

No.	Description	No.	Description
101	Dust ring DH28	124	Spring Pin $\Phi 5 \times 30$
102	O-ring d28x3.35	125	Seat Pin
103	Y-ring 28x36x5	126	Rear Wheel Axle
104	O-ring d5x2.65	127	Rear Wheel $\Phi 160 \times 50$
105	Oil Screw M8x10	128	Shaft Spring Ring 17
106	Lift Piston Rod	129	Dust Cap
107	Ball S $\Phi 18$	130	Adjusting Screw M6x25(+Nut)
108	Pump Piston Rod	131	Lowering Lever
109	Spring Cap	132	O-ring $\Phi 4.87 \times 1.8$
110	Spring $\Phi 42 \times 5 \times 96$	133	Oil Drainage Rod
111	Dust ring	134	Oil Drainage Rod Spring $\Phi 7.5 \times 1.2 \times 25$
112	Y-ring 16x22x8	135	Pressure Adjustment Valve Screw M10x1x12
113	Bolt M14x1.5	136	O-ring d4.87x1.8
114	Washer $\Phi 14 \times 1.2$	137	Pressure Adjustment Screw M10x1x9
115	Valve Jacket Spring $\Phi 9.5 \times 1.5 \times 12.5$	138	Pressure Adjustment Spring $\Phi 8 \times 2 \times 16.5$
116	Valve Disk Spring $\Phi 5.5 \times 0.7 \times 15$	139	Spring Seat
117	Valve Jacket	140	Ball S $\Phi 6$
118	Ball S $\Phi 9$	141	Handle Pin
119	Ball S $\Phi 6$	142	Spring Pin $\Phi 5 \times 30$
120	Bearing Washer	143	Rear Wheel Axle 6303
121	Thrust Ball Bearing 51108	144	Seat
122	Shaft Spring Ring 40	145	Forced Filling Oil Cup
123	Spring Pin $\Phi 5 \times 40$		

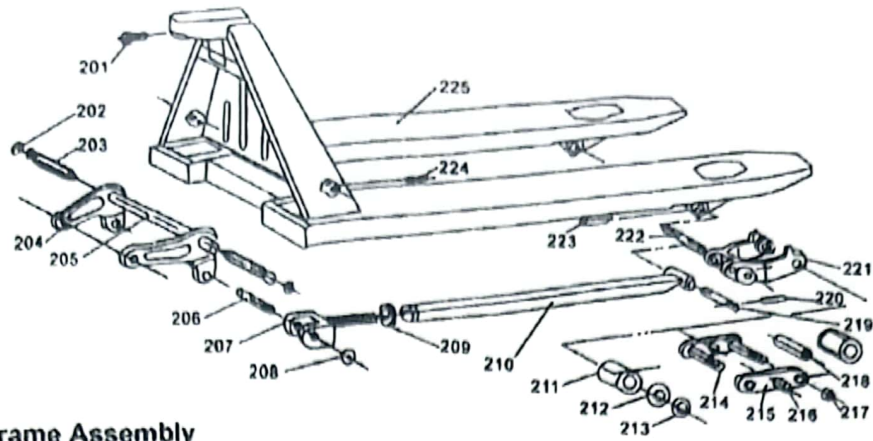

200 Frame Assembly

No.	Description	No.	Description
201	Bolt M8×15	214	Hexagon Bolt M10×80
202	Shaft Spring Ring 18	215	Balance Arm
203	Arm Pin	216	Balance Arm Axle Head
204	Arm (L/R)	217	Locknut M10
205	Arm Connection	218	Shaft Jacket
206	Push Rod Pin	219	Push Rod Shaft
207	Push Rod Fork	220	Spring PinΦ4×25
208	Shaft Spring Ring 16	221	Front Wheel Frame
209	Round Nut M18×1.5	222	Wheel Frame Axle
210	Push Rod	223	Spring PinΦ5×30
211	Front WheelΦ70×60	224	Spring PinΦ4×30
212	Bearing6303	225	Frame
213	Round Washer		

300 Handle Assembly

No.	Description
301	Handle
302	Spring Plate
303	Spring Pin Φ4×30
304	Roller
305	Spring Pin Φ4×16
306	Control Lever
307	Spring PinΦ4×14
308	Spring PinΦ6×30
309	Pressure Roller
310	Pressure Roller Shaft
311	Shaft Spring Ring 12
312	Release Rod
313	Roller Chain 25H×19
314	Hinge Screw
315	Adjusting Nut M5

